



PGP Steering Committee Meeting  
November 12, 2020 4:15 pm  
ZOOM

**Steering Committee:** Dianne Bates, JD Beltran, Jean Bogiages, Daniel Sheeter, Sheldon Trimble, Kanwar Kelley, Steven Solomon, JR Eppler

**Potrero Gateway Eco-Patch:** Alex Harker, Eddie Bartley, Noreen Weeden, Terri McFarland, Dianne Bates

**GBD:** Julie Christensen, Executive Director

### Notes

The Meeting opened at 4:20

#### **Review of PGP and Vermont Street -budgets, timelines, drawings**

Jean presented Attachment A to review the background of the Potrero Gateway Project

#### **Proposal to write a Community Challenge Grant by the GBD.**

Kanwar described the traffic calming and open space benefits of adding meandering paths and community gardens in the area that is now the third lane on Vermont Street. The discussion centered around the area in the picture below - from the west side of a 6ft sidewalk to a location TBD in the Caltrans area.

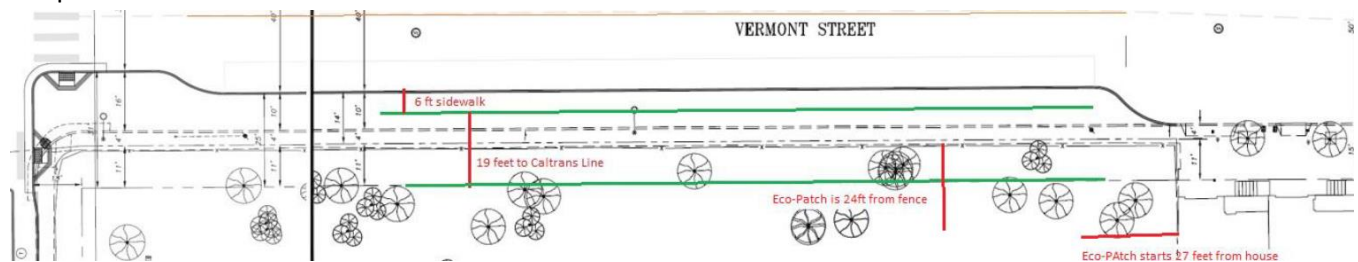

Yet to be determined:

Is the Caltrans western boundary for the CCG grant at the existing fence line or at the green line? Trent and Deanna at Public Works are researching that question.

Julie Christensen arrived at around 4:40 and answered questions about the plan for a Fletcher design and the matching funds expected from the GBD as well as from neighborhood volunteer work.

Individuals expressed support for using demoed concrete for planters, the zig-zag meandering path between plantings, a dog station near 17<sup>th</sup> Street and planting live Oaks,

It was agreed that Alex should review the drawings and the proposal before it is submitted.

It was agreed that Julie would send the drawings to the group once Fletcher creates them.

The meeting is recorded on a ZOOM mp4 for review.



## Letter of Recommendation

The combined group supported approval for the concept idea of a CCG grant for landscape gardens supporting the Eco-Patch native habitation, in the open space where the old sidewalk and the former 3<sup>rd</sup> lane currently exist.

Attendees:



# PGP 17<sup>th</sup> Street

Progress to Date

11/12/2020

# Contents

Schedule and ROM Estimates .....	3
Project extent as of February 13, 2020.....	4
Design Elements as of February 13,2020.....	5
Original Options for Vermont Street.....	6
17 <sup>th</sup> Street Bike Safety Proposals.....	7
Current Draft for 17 <sup>th</sup> Street with 6ft sidewalk option.....	8
Annotated PW Streetscape Drawing.....	9
Initial Fletcher Studio Draft.....	10

# Schedule and Funding

Design Deliverable Milestones	Target Date
35% Design PS&E	10/30/2020
65% Design PS&E	1/25/2021
95% Design PS&E	3/26/2021
100% Design PS&E	6/20/2021
Construction Milestones	Target Date
Ready to Advertise	7/11/2021
Bid Opening	9/9/2021
Award and Certify Contract	10/9/2021
Notice to Proceed (NTP) – Start Construction	10/19/2021
Substantial Completion	1/17/2022

Initial Income for the PGP project

FY	Source	Public Works Budget	Allocated for
16/17	IPIC (Awarded by ENCAC)	\$300,000	Streetscape
16/17	Addback (from Public Works)	\$50,000	Land Survey
17/18	IPIC (Awarded by ENCAC)	\$1,450,000	Open Space
17/18	Addback (from D10 Supervisor)	30,000	Geotech
17/18	AHSC Grant	\$700,000	Construction
17/18	Prop AA Grant	\$300,000	Construction
15/16	CNG (MOHCD)	\$199,470	Design
18/19	CNG (MOHCD)	\$80,000	Design
17/18	Donations to GBD	\$6,000	Eco-Patch
19/20	Donation from Spear Street Capital	\$7,500	Limit of Work Drawing
<b>Total</b>		<b>\$3,122,970</b>	

Public Work's May 29 ROM expense estimate

PW POTRERO GATEWAY PARK		ROM Estimate for Phase 1		5/29/2020
<b>PLANNING</b>			\$ 190,000.00	
<b>DESIGN</b>			\$ 480,000.00	
CONSTRUCTION SCOPE		CONSTRUCTION COSTS	CONSTRUCTION SOFT COSTS	SUBTOTAL
<b>HARDSCAPE</b>				
17th South Sidewalk Widening		\$ 165,000.00	\$ 66,000.00	\$ 231,000.00
17th & San Bruno Bulb-out		\$ 85,000.00	\$ 34,000.00	\$ 119,000.00
17th & Vermont Corner		\$ 70,000.00	\$ 28,000.00	\$ 98,000.00
Vermont Sidewalk Widening		\$ 280,000.00	\$ 112,000.00	\$ 392,000.00
<b>HARDSCAPE TOTAL</b>		<b>\$ 600,000.00</b>	<b>\$ 240,000.00</b>	<b>\$ 840,000.00</b>
<b>LANDSCAPE</b>				
17th & San Bruno Corner		\$ 175,000.00	\$ 70,000.00	\$ 245,000.00
17th & Vermont Corner		\$ 175,000.00	\$ 70,000.00	\$ 245,000.00
Vermont Sidewalk (Option 1)		\$ 50,000.00	\$ 20,000.00	\$ 70,000.00
<b>LANDSCAPE TOTAL</b>		<b>\$ 400,000.00</b>	<b>\$ 160,000.00</b>	<b>\$ 560,000.00</b>
<b>CONSTRUCTION TOTAL</b>		<b>\$ 1,000,000.00</b>	<b>\$ 400,000.00</b>	<b>\$ 1,400,000.00</b>
<b>PHASE 1 GRAND TOTAL</b>			<b>\$ 2,070,000.00</b>	

Budget given to SFAC for Art Under the Bridge

TOTAL ART ENRICHMENT	Amount	Percent
Project Management	\$100,000.00	20%
Conservation Reserve	\$50,000.00	10%
Art	\$350,000.00	70%
<b>Total</b>	<b>\$500,000.00</b>	<b>100%</b>

# Extent of Work

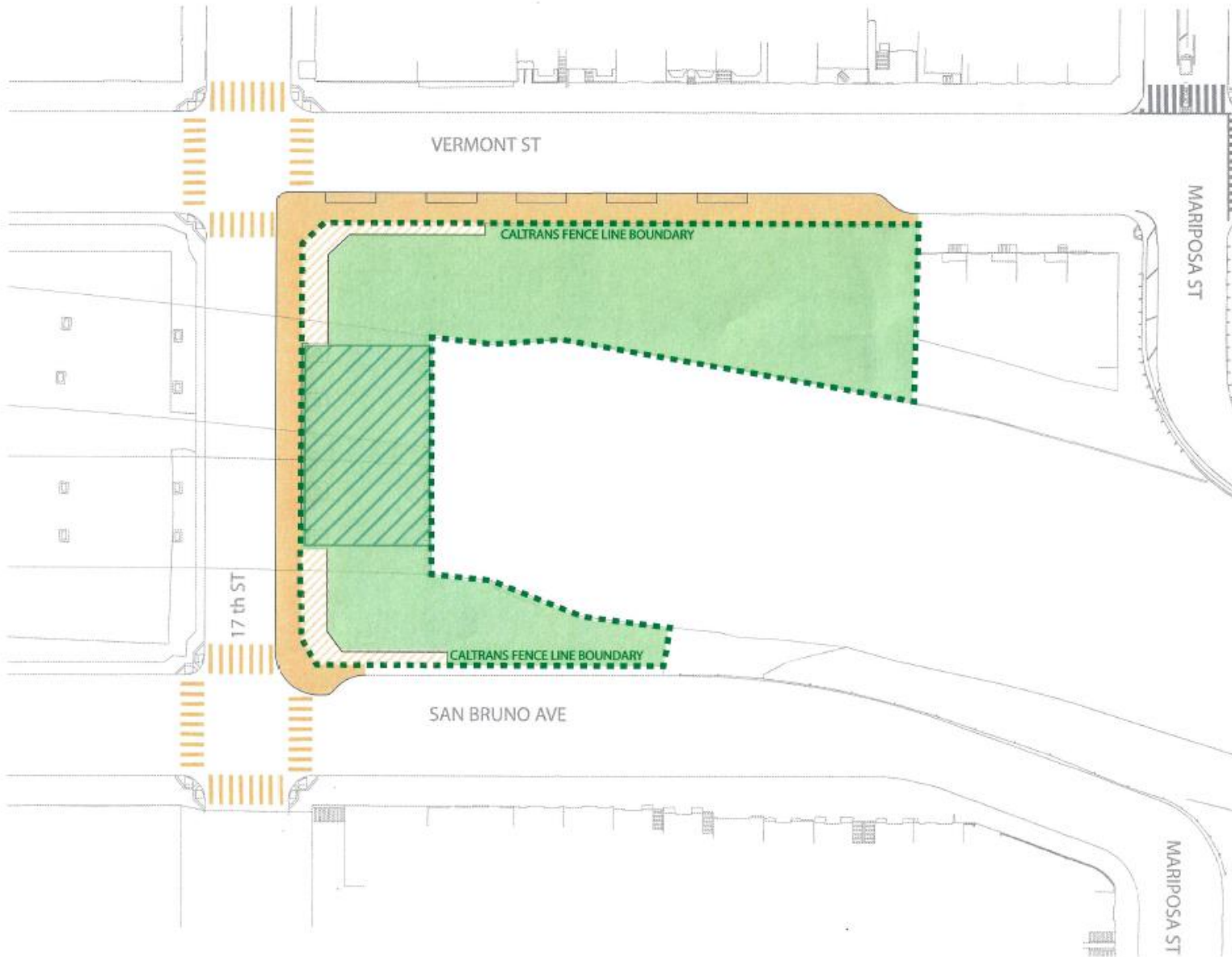

## Phase 1: STREETScape IMPROVEMENTS

- widened sidewalk
- street trees
- decorative paving
- decorative crosswalk
- identity markers
- pedestrian lighting
- rain garden
- enhanced corners

## Phase 2: CALTRANS PROPERTY IMPROVEMENTS

- fencing
- landscaping
- soil stabilization (hardscape)
- soil stabilization (vegetated)

## Phase 3: ART



- lighting
- sculpture
- mural

# Caltrans Property Improvement: Design Elements

1 FENCING



2 LIGHTING



3 TIERED PLANTING



4 SLOPE STABILIZATION



Draft | February 13, 2020

OPTION 1

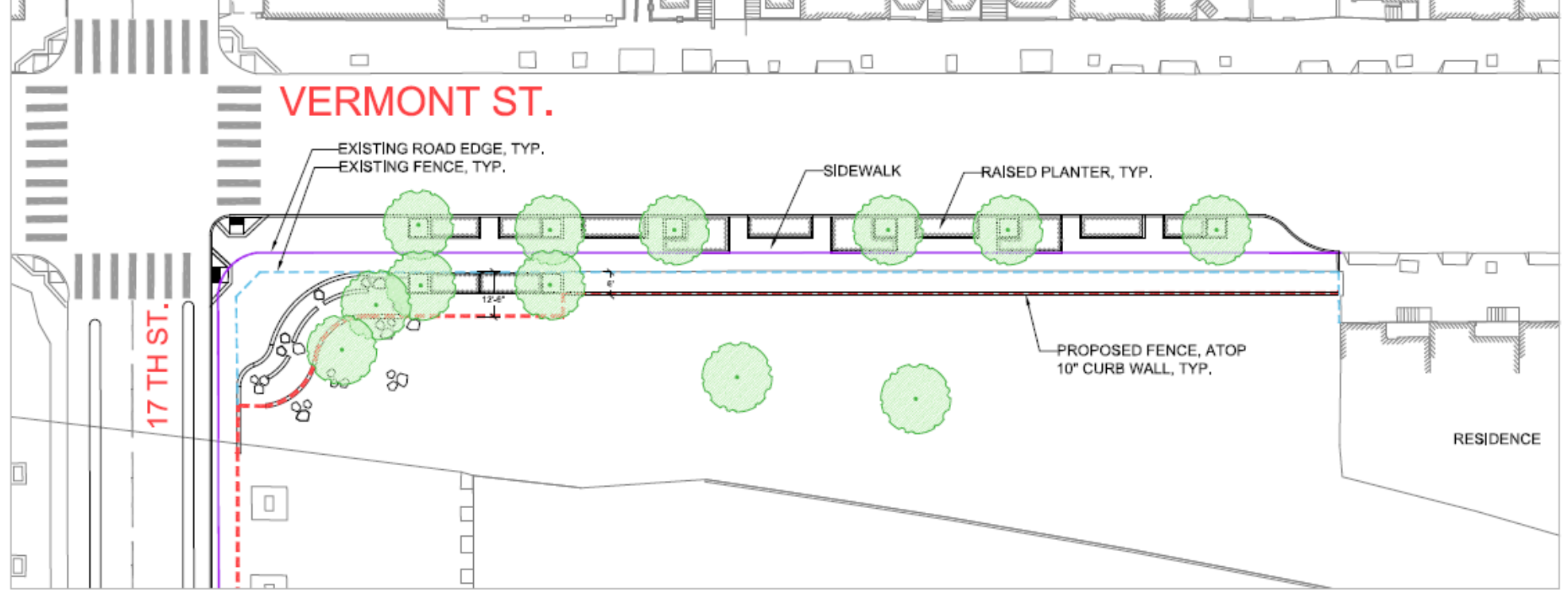

OPTION 2

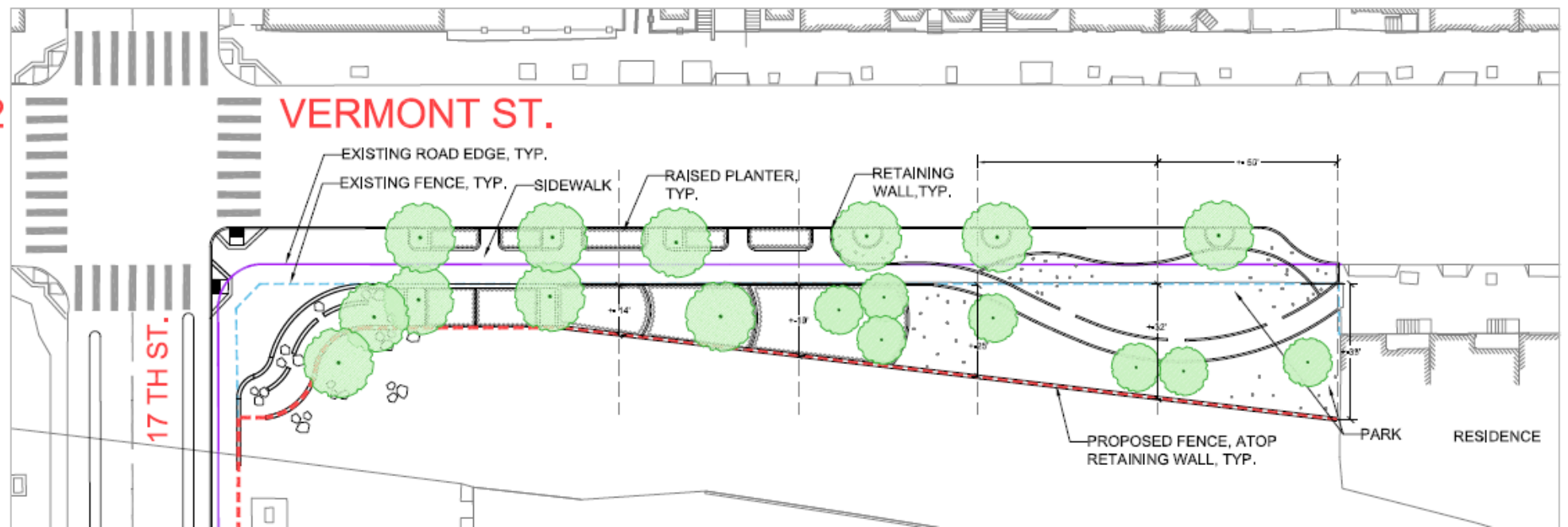



# 17<sup>th</sup> Street Streetscape Plan

6/18/20 call

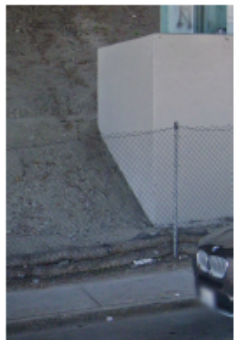
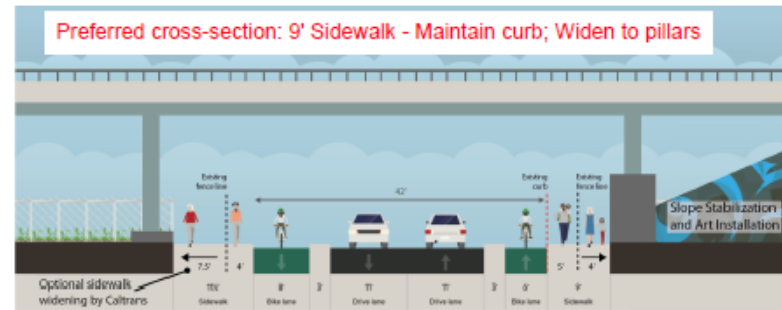
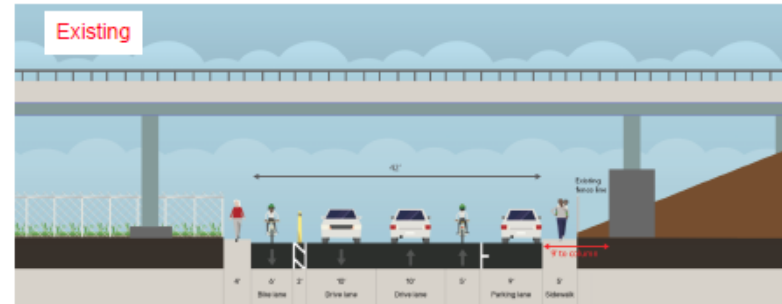
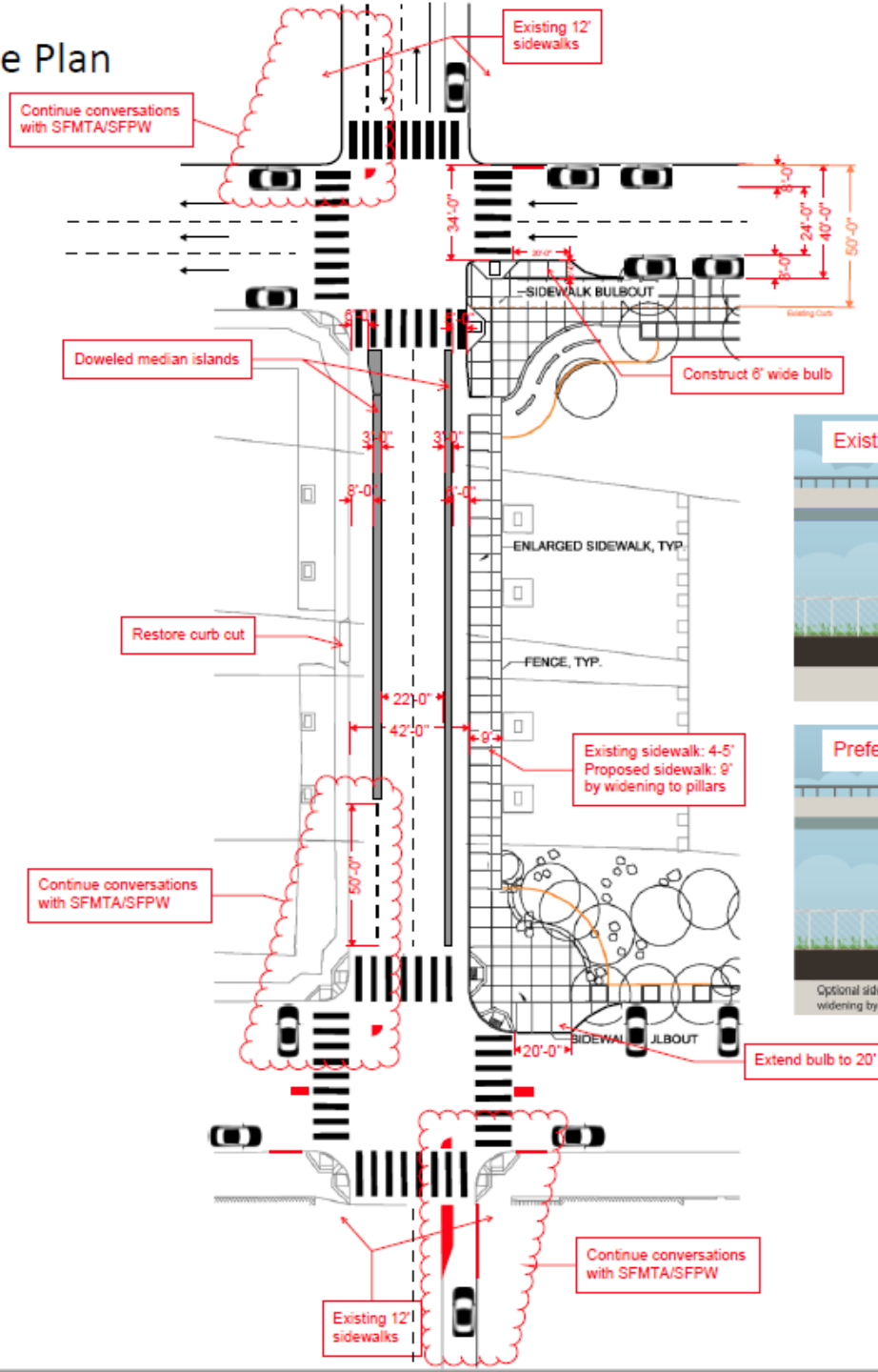

# VERMONT ST.

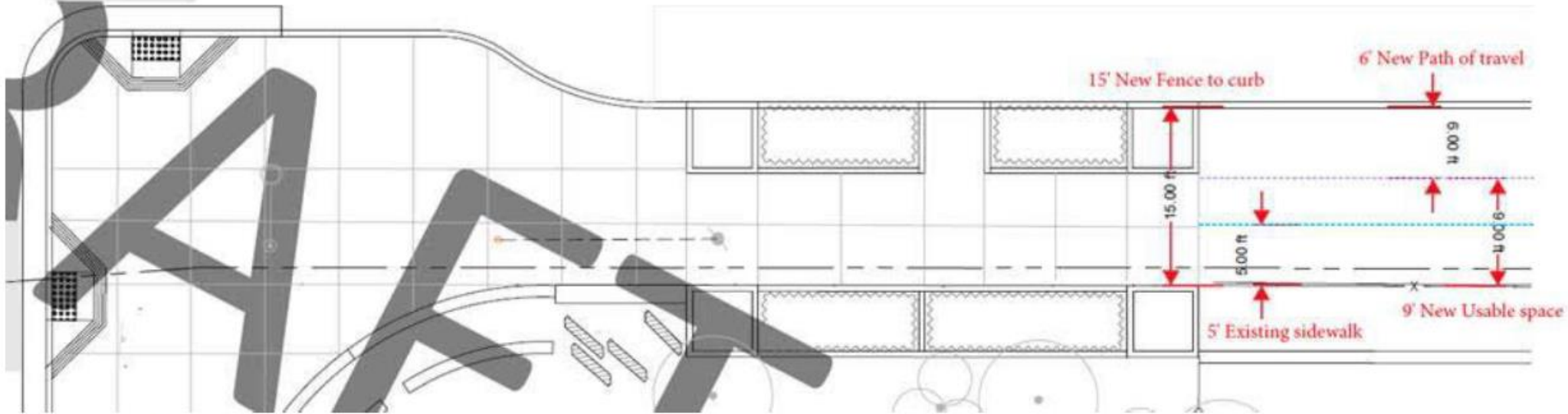

## General Scope:

(Existing) 5' Sidewalk

(New) 15' Fence to Curb/Road

Expanded sidewalk runs from 17th corner to Vermont residence

## Possible option:

6' Sidewalk (Path of Travel) from Curb/Road

9' of usable space

Small curb to separate path of travel from this space

Community can implement native planting meeting your request or City can build planters/landscaping

Alternative could be a 15' path of travel (concrete sidewalk) from Fence to Curb/Road

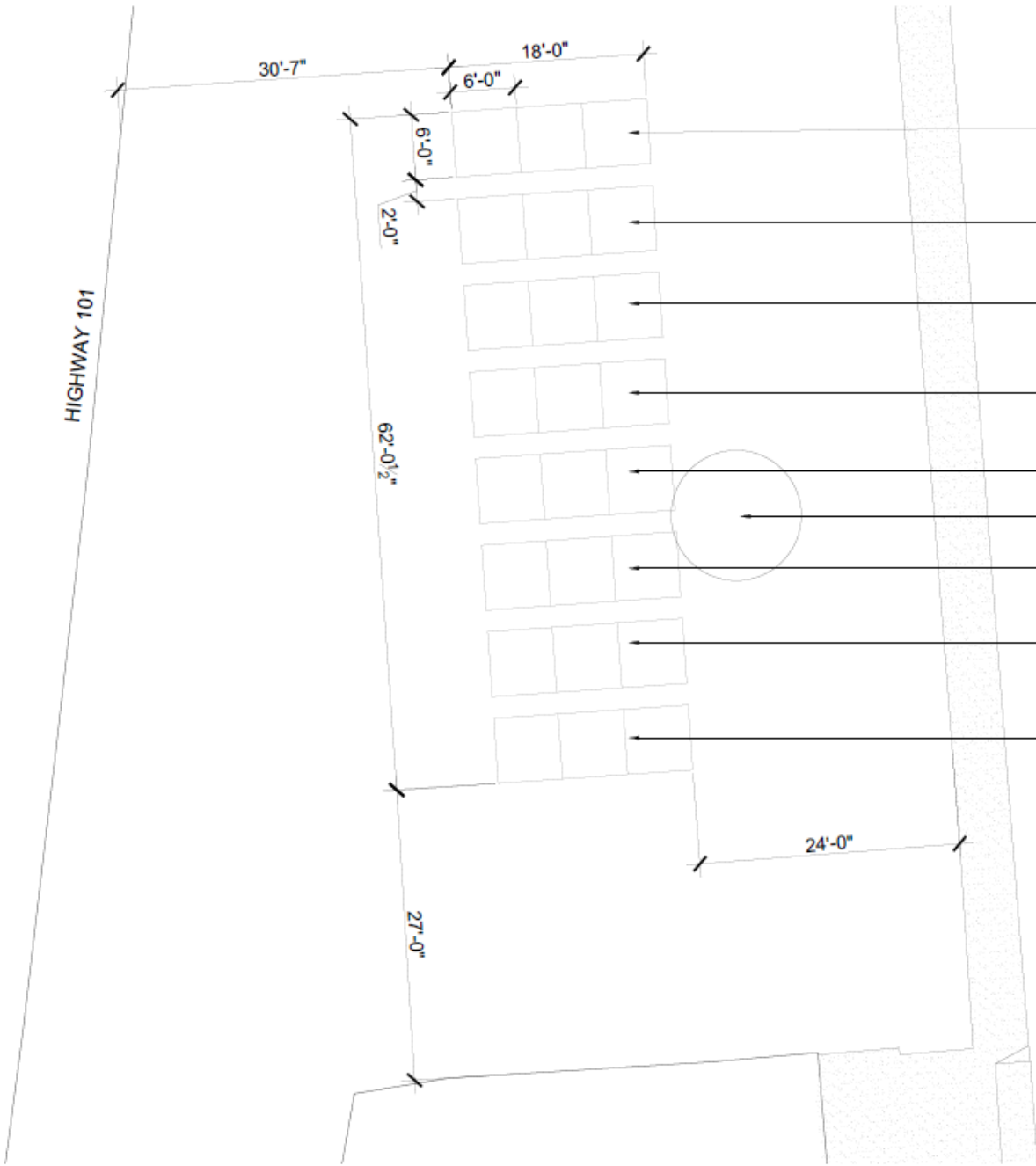

PLANT STUDY AREA 1

PLANT STUDY AREA 2

PLANT STUDY AREA 3

PLANT STUDY AREA 4

PLANT STUDY AREA 5

EXISTING QUERCUS AGRIFOLIA

PLANT STUDY AREA 6

PLANT STUDY AREA 7

PLANT STUDY AREA 8

DRAFT

Potrero Gateway Eco-Patch  
San Francisco, Ca.

Job Number	00-001
Drawn by	
Checked by	
Date	12/11/07
Date	December 11, 2007
Revisions	000/0000

OVERALL SITE PLAN

VERMONT STREET



L0.0

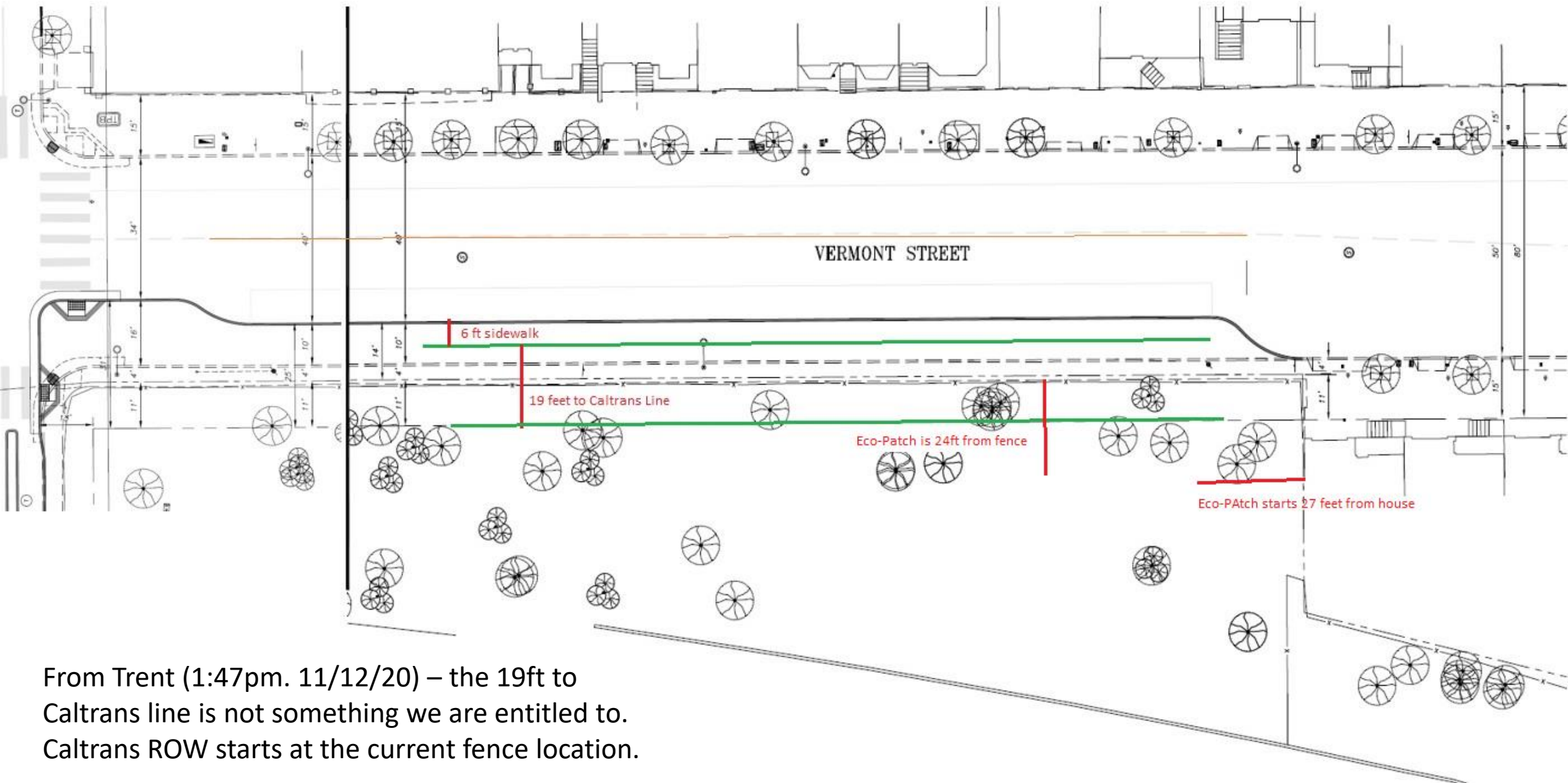

From Trent (1:47pm. 11/12/20) – the 19ft to Caltrans line is not something we are entitled to. Caltrans ROW starts at the current fence location.



### Fletcher Studio Option 1 (parking retained)

Maze or loop pathway

Auto access

Raised planters, dog station, art, native plants, tutorial signage, etc.

Varied pathway options

Informal gathering areas

Good transition to future Gateway improvements